

Instructions For: EvolutionRO1000 Wall mount bracket - stainless steel, heavy duty.

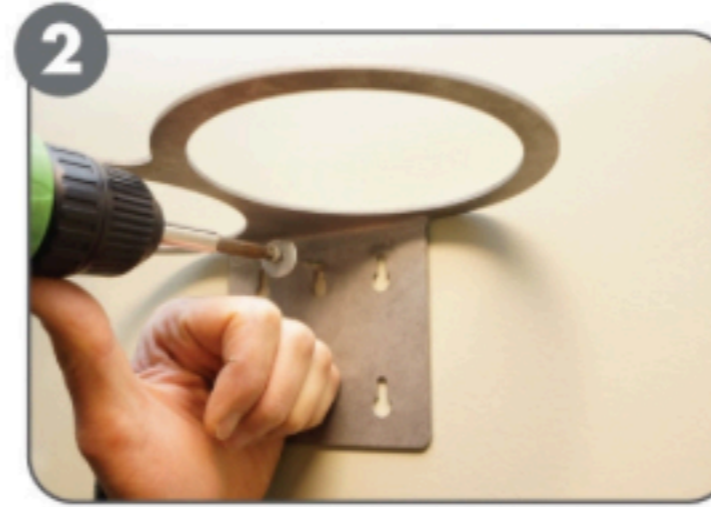

1 Locate stud using a stud finder or other means. If mounting to a stud, use at least two screws in the center of the stud to secure the bracket. If using a mounting board, use at least four screws to secure.

2 Screw at least two screws and two washers into located studs using the center holes.



3 Gently place the Evolution RO1000 into the mounting bracket.



Included

- Mounting Bracket
- Four Screws
- Four Washers

www.hydrologicsystems.com

WARNING! - Hydro-Logic is not responsible for failures due to inappropriate mounting materials or methods



youtu.be/TvGhP6hpXLo